

GENERAL INFORMATION

LAMINATED DUCTING

DEC INTERNATIONAL, producer of flexible ducting for air management systems and heating systems (HVAC)

The abbreviation '**DEC**' stands for **Dutch Environment Corporation bv**, trading its products under the name **DEC International**, is established in Enschede (The Netherlands) with a facility for the production and distribution of flexible ducting. Over the years **DEC** has become one of the world's largest manufacturers of flexible ducting systems and is recognized globally for its superior quality, its machine engineering and services.

The production process is certified according to **ISO9001:2008**.

DEC INTERNATIONAL'S SPECIAL DUCT CONSTRUCTIONS

The DEC-laminate has been constructed out of a "sandwich construction".
The polyester layer and the aluminium foil are shifted with respect to each other.

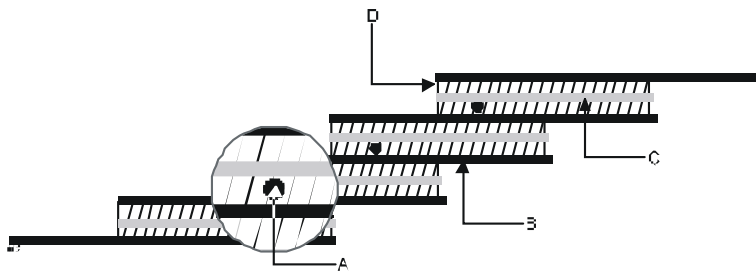

- A. wire
- B. polyester layer
- C. aluminium foil
- D. adhesion

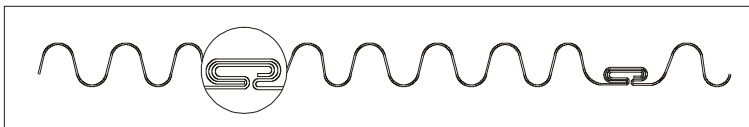

PURE METAL DUCTS

The normal pure metal ducts have been produced with a folded seam.

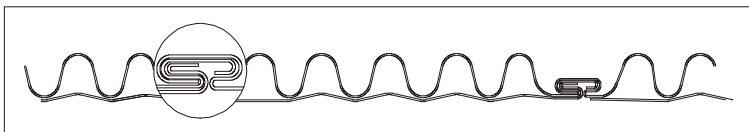

DEC International, however, has produced a few products more solid. This means that these connections have a double folded seam. This connection is used in products like the Flueliners.

LIABILITY:

The information contained in this brochure was current on the publication date. DEC INTERNATIONAL reserves the right to make changes in details at any time without prior notice. In order to avoid misunderstandings, any interested party is advised to contact DEC INTERNATIONAL checking for any changes in materials and/or information after this brochure was published.

PLEASE NOTICE:

The consultant is responsible for the actual installation and mounting of the product. The mentioned values with respect to temperatures are not appropriate to be used to determine the physical properties. These properties are also dependent on humidity and the temperature of the air inside and outside of the H.V.A.C. system.

TRADEMARKS:

The DEC logo and DEC International are trademarks, or registered trademarks of Dutch Environment Corporation BV in the Netherlands and/or other countries.

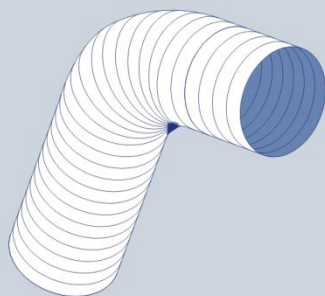

GENERAL INFORMATION

LAMINATED DUCTING

OPTIONS IN RESPECT TO HOUSE CONSTRUCTION

Application	Product	Properties
Mechanical exhausting	<ul style="list-style-type: none"> Aludec Combidec Greydec 	<ul style="list-style-type: none"> up to 250 °C up to 140 °C up to 70 °C different chemical resistance
Air heating	<ul style="list-style-type: none"> Isodec Sonodec 	<ul style="list-style-type: none"> T insulated T + A insulated
Toilet exhausting	<ul style="list-style-type: none"> Aludec Greydec 	<ul style="list-style-type: none"> up to 250 °C up to 70 °C
Mechanical ventilation	<ul style="list-style-type: none"> Aludec Combidec 	<ul style="list-style-type: none"> very flexible very flexible
Removing noise machines	<ul style="list-style-type: none"> Sonodec 	<ul style="list-style-type: none"> fire resistance tested
Combustion tube	<ul style="list-style-type: none"> Decflex Flueliner 	<ul style="list-style-type: none"> smooth inside
Chimney lining	<ul style="list-style-type: none"> Decflex Flueliner 	<ul style="list-style-type: none"> combustion gas resistant air supply
Insertion loss	<ul style="list-style-type: none"> Sonodec TRD 	<ul style="list-style-type: none"> attenuation in flow direction
Sound attenuation duct wall	<ul style="list-style-type: none"> Sonodec GLX 	<ul style="list-style-type: none"> increased attenuation duct wall
Insulation of existing channels	<ul style="list-style-type: none"> Isosleeve 	<ul style="list-style-type: none"> insulation jacket to attach easily

OPTIONS IN RESPECT TO BUILDING OF PUBLIC UTILITIES

Application	Product	Properties
Cooled air	<ul style="list-style-type: none"> Isodec Sonodec 	<ul style="list-style-type: none"> T insulated T+A insulated
Mechanical exhausting	<ul style="list-style-type: none"> Aludec Combidec Greydec 	<ul style="list-style-type: none"> up to 250 °C up to 140 °C up to 70 °C diff.chem.res.
Air heating	<ul style="list-style-type: none"> Isodec Sonodec 	<ul style="list-style-type: none"> T insulated T+A insulated
Toilet exhausting	<ul style="list-style-type: none"> Aludec Combidec Greydec Stretchdec Compacdec 	<ul style="list-style-type: none"> up to 250 °C, flexible up to 140 °C, flexible up to 70 °C, flexible up to 250 °C, rigid up to 250 °C, rigid
Mechanical ventilation	<ul style="list-style-type: none"> Aludec Combidec Stretchdec Compacdec 	<ul style="list-style-type: none"> aluminium laminate mechanical strengthened pure aluminium pure aluminium
Removing noise machines	<ul style="list-style-type: none"> Sonodec 	<ul style="list-style-type: none"> fire resistance tested
Exhaust- and ventilation duct	<ul style="list-style-type: none"> Combidec Greydec HP 	<ul style="list-style-type: none"> up to 140 °C up to 70 °C different chemical resistance
Chimney lining	<ul style="list-style-type: none"> Decflex Flueliner 	<ul style="list-style-type: none"> combustion gas resistant air supply purposes
Decreasing of sound level	<ul style="list-style-type: none"> Sonodec TRD 	<ul style="list-style-type: none"> increased attenuation in flow direction
Decreasing of noise	<ul style="list-style-type: none"> Sonodec GLX 	<ul style="list-style-type: none"> increased wall attenuation
Insulation of existing channels	<ul style="list-style-type: none"> Isosleeve 	<ul style="list-style-type: none"> insulation jacket to attach easily

EXPLANATION

T insulated = Thermically insulated

T+A insulated = Thermically and Acoustically insulated

LIABILITY:

The information contained in this brochure was current on the publication date. DEC INTERNATIONAL reserves the right to make changes in details at any time without prior notice. In order to avoid misunderstandings, any interested party is advised to contact DEC INTERNATIONAL checking for any changes in materials and/or information after this brochure was published.

PLEASE NOTICE:

The consultant is responsible for the actual installation and mounting of the product. The mentioned values with respect to temperatures are not appropriate to be used to determine the physical properties. These properties are also dependent on humidity and the temperature of the air inside and outside of the H.V.A.C. system.

TRADEMARKS:

The DEC logo and DEC International are trademarks, or registered trademarks of Dutch Environment Corporation BV in the Netherlands and/or other countries.

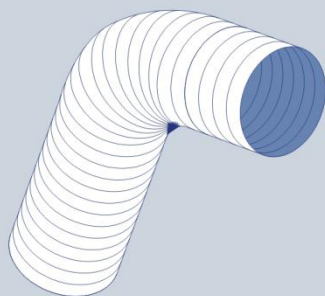

GENERAL INFORMATION

LAMINATED DUCTING

OPTIONS IN RESPECT TO INDUSTRY AND GENERAL

Application	Product	Properties
Exhaust hose	<ul style="list-style-type: none"> Decflex Fluelineer 	<ul style="list-style-type: none"> smooth inside
Exhausting welding vapours	<ul style="list-style-type: none"> Combidec 	<ul style="list-style-type: none"> static set up
Insulation (rain) water discharging	<ul style="list-style-type: none"> Isosleeve 	<ul style="list-style-type: none"> to attach easily
Air supply general	<ul style="list-style-type: none"> Aludec Compacdec Stretchdec 	<ul style="list-style-type: none"> aluminium laminate pure aluminium pure aluminium
Air supply higher temperatures	<ul style="list-style-type: none"> Aludec 112 	<ul style="list-style-type: none"> up to 250 °C
Higher temperature resistance	<ul style="list-style-type: none"> Decflex Fluelineer 	<ul style="list-style-type: none"> smooth inside surface
Chimney lining	<ul style="list-style-type: none"> Decflex Fluelineer 	<ul style="list-style-type: none"> combustion gas resistant ventilation
Decreasing of sound	<ul style="list-style-type: none"> Sonodec TRD 	<ul style="list-style-type: none"> increased attenuation in flow direction
Decreasing of sound	<ul style="list-style-type: none"> Sonodec GLX 	<ul style="list-style-type: none"> increased attenuation in duct wall
Insulation of existing channels	<ul style="list-style-type: none"> Isosleeve 	<ul style="list-style-type: none"> insulation jacket to attach easily

OPTIONS IN RESPECT TO SPECIAL APPLICATIONS

Application	Product	Properties
Clothes drier	<ul style="list-style-type: none"> PVC 	<ul style="list-style-type: none"> up to 70 °C
General air supply purposes	<ul style="list-style-type: none"> Aludec 	<ul style="list-style-type: none"> very flexible
Chimney lining	<ul style="list-style-type: none"> Decflex Fluelineer 	<ul style="list-style-type: none"> combustion gas resistant ventilation
Decreasing of sound	<ul style="list-style-type: none"> Sonodec TRD 	<ul style="list-style-type: none"> increased attenuation in flow direction
Decreasing of sound	<ul style="list-style-type: none"> Sonodec GLX 	<ul style="list-style-type: none"> increased attenuation of the duct wall

EXPLANATION

T insulated = Thermically insulated
T+A insulated = Thermically and acoustically insulated

LIABILITY:

The information contained in this brochure was current on the publication date. DEC INTERNATIONAL reserves the right to make changes in details at any time without prior notice. In order to avoid misunderstandings, any interested party is advised to contact DEC INTERNATIONAL checking for any changes in materials and/or information after this brochure was published.

PLEASE NOTICE:

The consultant is responsible for the actual installation and mounting of the product. The mentioned values with respect to temperatures are not appropriate to be used to determine the physical properties. These properties are also dependent on humidity and the temperature of the air inside and outside of the H.V.A.C. system.

TRADEMARKS:

The DEC logo and DEC International are trademarks, or registered trademarks of Dutch Environment Corporation BV in the Netherlands and/or other countries.